

LED EYE-PROTECTIVE LAMP OPERATING MANUAL

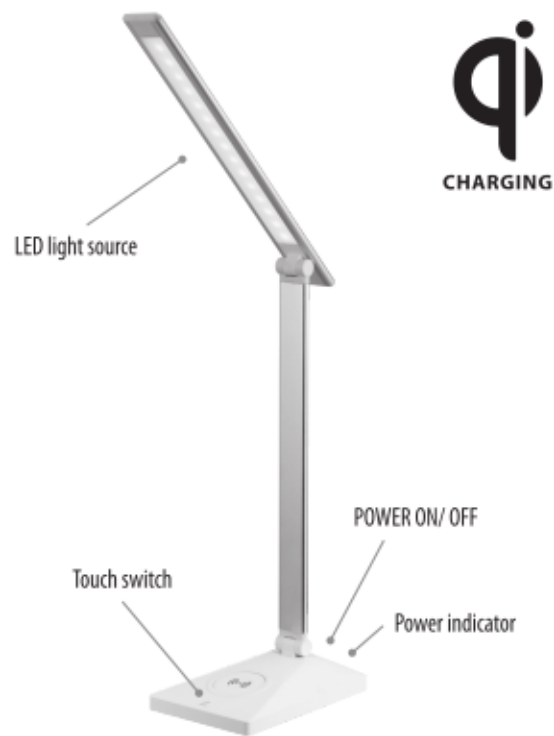

Thank you for your purchase, please read the manual carefully in order to know the products sufficiently, for future use, please keep it well after read.

PRODUCT COMPONENT

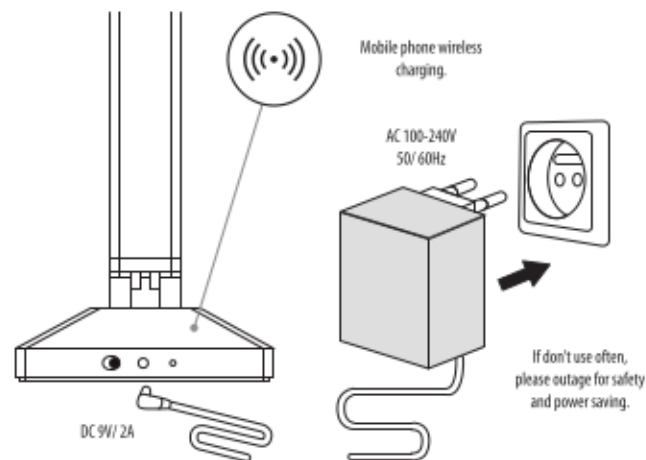

PERFORMANCE FEATURE

- The lamp of simple design, great beauty.
- LED light source, soft and uniform light ray no RF, protect eye.
- Touch control dimming.
- Power supply with DC 9V/ 2A LED driving power.



No skin injury



Anti-dazzle light filter



No mercury, no lead

TECHNICAL PARAMETERS

Shell material	ABS + PS	Input	DC 9V/ 2A
Color temperature:	3000 K/ 4500 K/ 6000 K		
Luminous flux	200 lm	CRI	>80
Power	5 W	N.W	489 g
Wireless charging output power	Compatible with 5 W/ 7.5 W/ 10 W/ 15 W		
Product size	161x110x400 mm		

ON/OFF KEY: touch key turn on/off the led lamp.

LED lights brightness control:

In condition of turn on the light, touch key more than three seconds, can adjust light brightness, loosen to confirm the current brightness, the product has brightness memory function.

Notes:

1. Please wait for 3-5 seconds to start using the touch button.
2. Please use the appropriate LED drive together with lamp.



These devices do not belong in household waste, but there are separate waste removal.

